

South Carolina

Pursuant to a warrant from John Thomas Esq. Com<sup>r</sup> of Locations N<sup>o</sup> Saluda dated this day I have admeasured & laid out unto Sampson Boto a Tract of One hundred and Ninety six acres of land on the Branches of two mile Creek of Enoree River in Spartanburg County, Bounded N<sup>o</sup> N<sup>o</sup> E & East on Joseph Woffords and Isaac Crow's Land S<sup>o</sup> S<sup>o</sup> W<sup>o</sup> N<sup>o</sup> W<sup>o</sup> on Joseph Barnetts Heirs Land S<sup>o</sup> W<sup>o</sup> on Edward Nash's Land S<sup>o</sup> E on ~~William~~ William Fullers & William Wilkins Land and hath such Shape and marks as the above plat Represents. Surveyed the 16<sup>th</sup> day of Oct<sup>r</sup> 1792

Robert Hanna Dep<sup>y</sup> Sur<sup>v</sup>

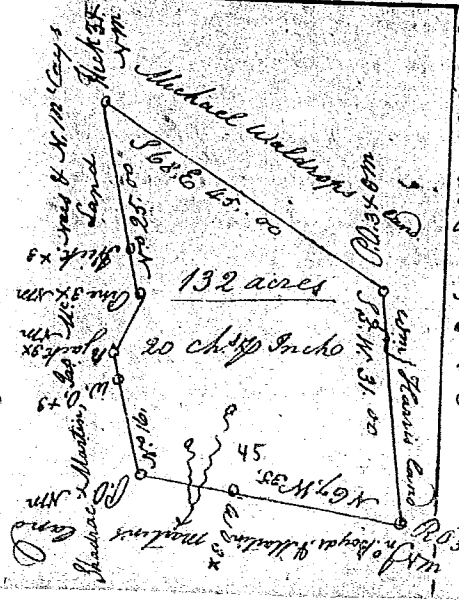

South Carolina.  
Pursuant to a Warrant from John Thomas Esq. Com<sup>r</sup> of Locations in the district of 96 dated the 13<sup>th</sup> of Sept<sup>r</sup> 1792 N<sup>o</sup> Saluda River. I have admeasured and laid out unto James Young a tract of One hundred and thirty two acres of land in Laurens County on the branches of Little River waters of Saluda Bounding by a line turning S<sup>o</sup> E by land surveyed for Michael Wallings S<sup>o</sup> W<sup>o</sup> by Wm Harris Land N<sup>o</sup> W<sup>o</sup> by John Boyd and Martin Martins Land N<sup>o</sup> E by Shadrach Martin James M. Nees, & Nathaniel M. Coys Land, and hath such form and marks as the above plat Represents.

Surveyed the 13<sup>th</sup> Sept<sup>r</sup> 1792 by me  
Agnes Gorley D<sup>s</sup>